

2002B,2002BG

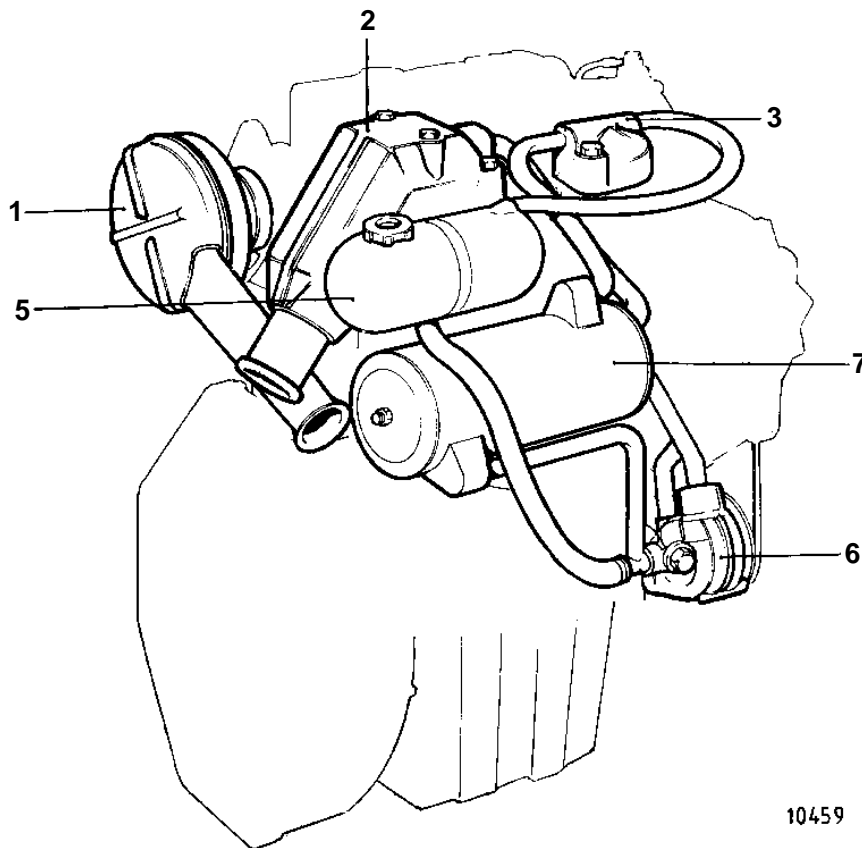
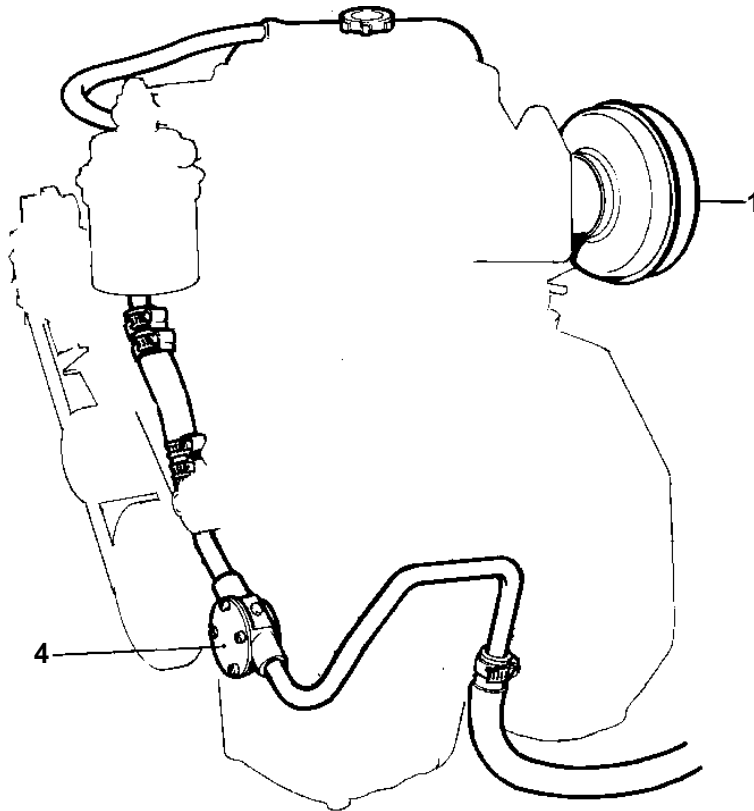

10459

**COOLING SYSTEM, INDUCT. AND EXHAUST MANIFOLD.
 FRESHWATER-COOLED ENGINE: PR NO 868401,-402,-403,-613,-614.**

02B

2002B,2002BG

REF	QTY	DESCRIPTION	SEE SEC.
1	1	AIR FILTER WITH INSTALLATION COMPONENTS	02B-0220
2	1	EXHAUST BEND WITH INSTALLATION COMPONENTS	02B-0220
3	1	THERMOSTAT HOUSING WITH INSTALLATION COMPONENTS	02B-0220
4	1	SEA WATER PUMP WITH INSTALLATION COMPONENTS	02B-0530
5	1	EXPANSION TANK WITH INSTALLATION COMPONENTS	02B-0695
6	1	CIRKULATION PUMP WITH INSTALLATION COMPONENTS	02B-0760
7	1	HEAT EXCHANGER WITH INSTALLATION COMPONENTS	02B-0785